



**S2C.60**

**S SERIES**







**MODEL**

**S2C.60**  
double hinged leaf



MODEL

**S2C.60**

## description

Wooden hinged door with frame and leaf coplanar on one side. The frame is made of solid wood pieces. Acoustic and intumescent seals ensure the necessary tightness against flames and hot gases, as well as a high acoustic attenuation.

The leaf is made of a solid wood edge and contains acoustic and thermal insulating materials according to TRIA's construction system.

An automatic seal can be incorporated into the leaf.

The pivoting behavior of the door is ensured by hidden or visible hinges.

The automatic closing of the leaves is ensured by a hidden or visible door close

## specification

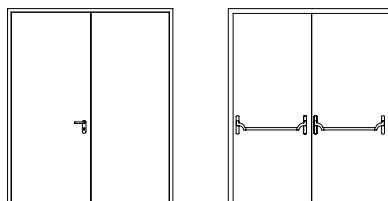

model | typology

**S2C.60** | double hinged leaf

## classification achieved when tested

FR integrity (EN 1634-1)	E 60
FR integrity and insulation (EN 1634-1)	EI <sub>1</sub> 60 / EI <sub>2</sub> 60
acoustic (ISO 717 -1)	-- dB

classification according to standard 13501-2

## dimensions (mm)

W x H (standard) <sup>(1)</sup>	1400 / 1600 x 2000 / 2100
W maximum	2820
H maximum	3130
external frame (standard)	W + 124 x H + 62
other dimensions	upon request

<sup>(1)</sup> W x H = width x height = free passage

## construction

leaf thickness (mm)	70
leaf weight (kg/m <sup>2</sup> )	30
hinges	hidden / apparent
finishing (standard)	mdf to paint
finishing (optional)	veneering in various woods / materials / lacquering
vision panel (optional)	400 mm x 1500 mm   Ø300 mm

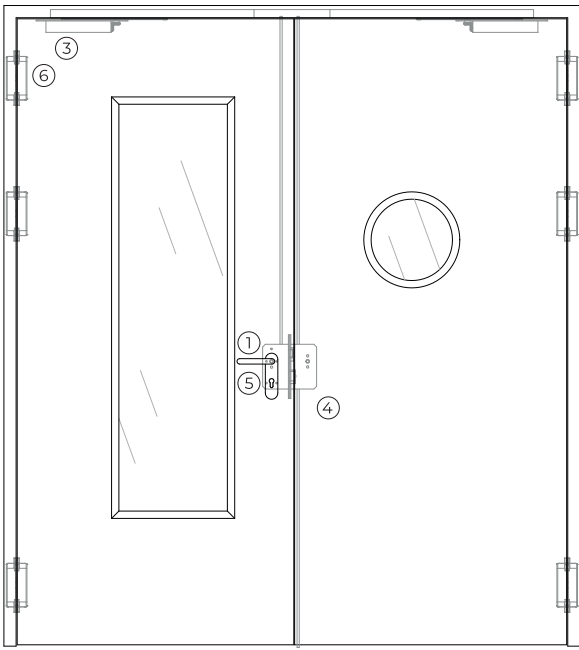

exterior view

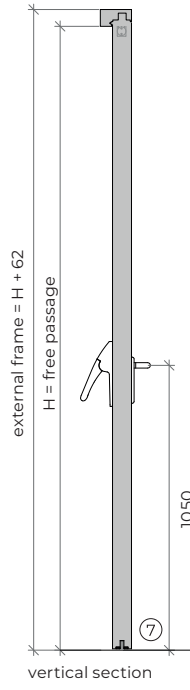

vertical section

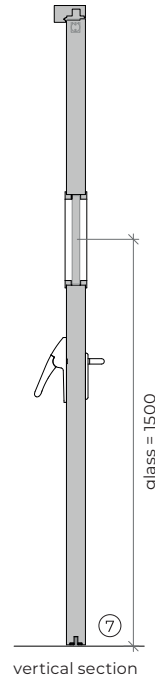

vertical section

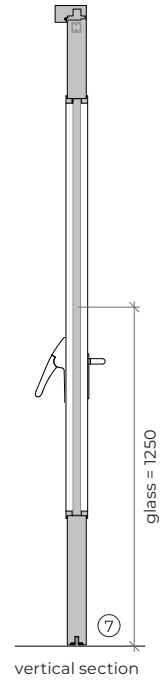

vertical section

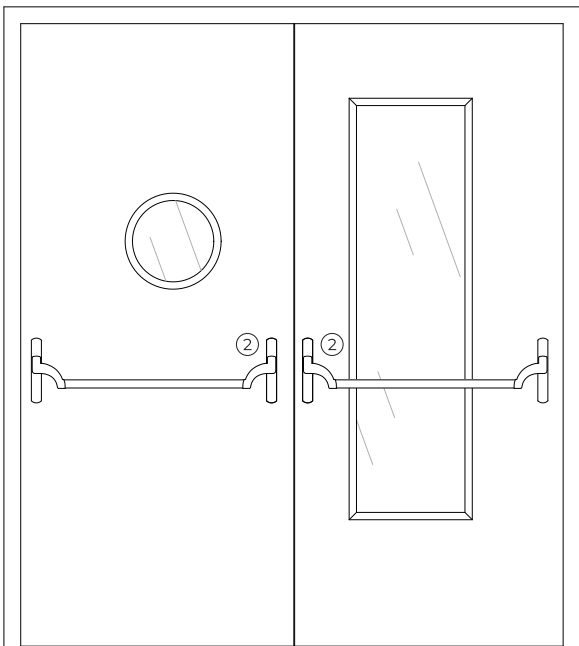
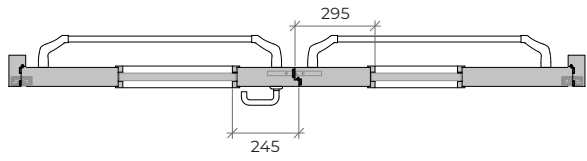
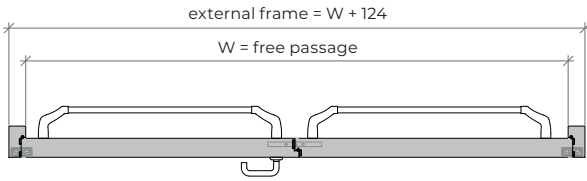

interior view

## accessories and hardware

<b>handle / bar <sup>(2)</sup></b>	1	standard	anti-panic lever handle with drill finished in black (standard) or stainless steel.
	2	standard	anti-panic bar with gear unit, tube, cover caps and arms finished in nylon black (standard) or stainless steel.  <sup>(2)</sup> alternatively, the door may be equipped with a pair of handles.
<b>hydraulic door closer <sup>(3)</sup></b>	3	standard	hidden door closer + closing sequence selector.  <sup>(3)</sup> with electromagnetic hold-open (optional)
<b>lock / counter lock</b>	4	standard	anti-panic lock + counter lock.
<b>cylinder</b>	5	standard	1/2 cylinder (european profile).
<b>hinges</b>	6	standard	hidden hinges of this series
<b>others</b>	6	optional	automatic seal.

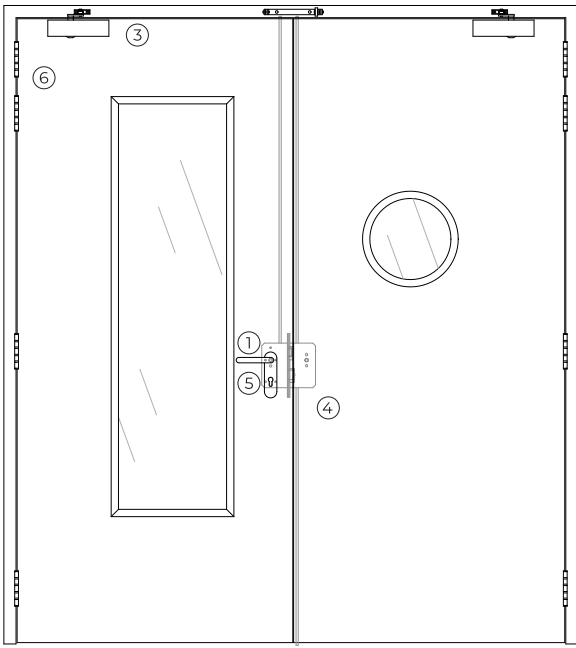

exterior view

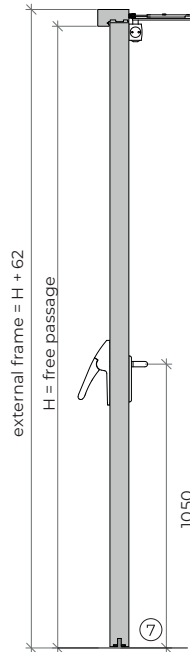

vertical section

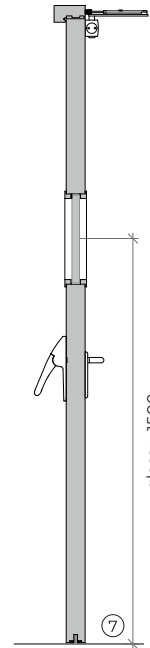

vertical section

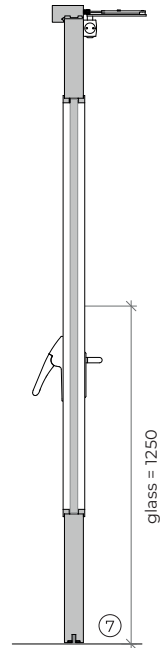

vertical section

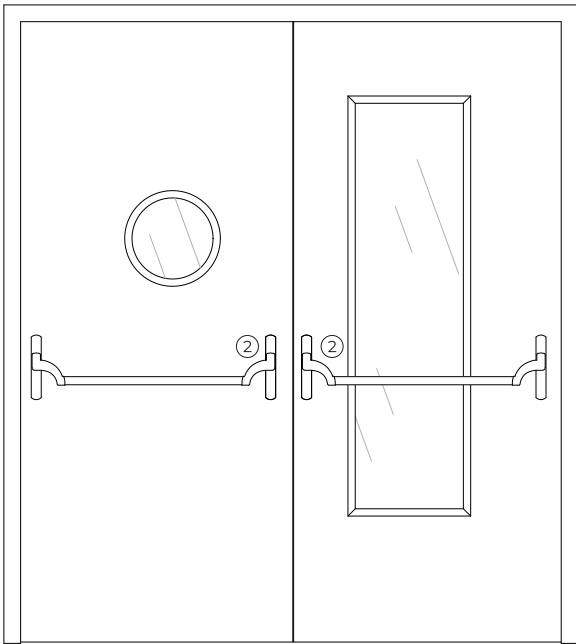
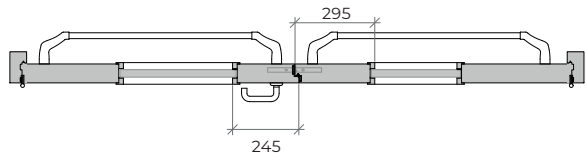
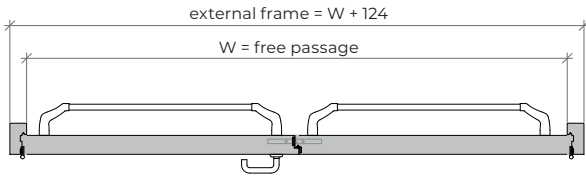

interior view



## optionals

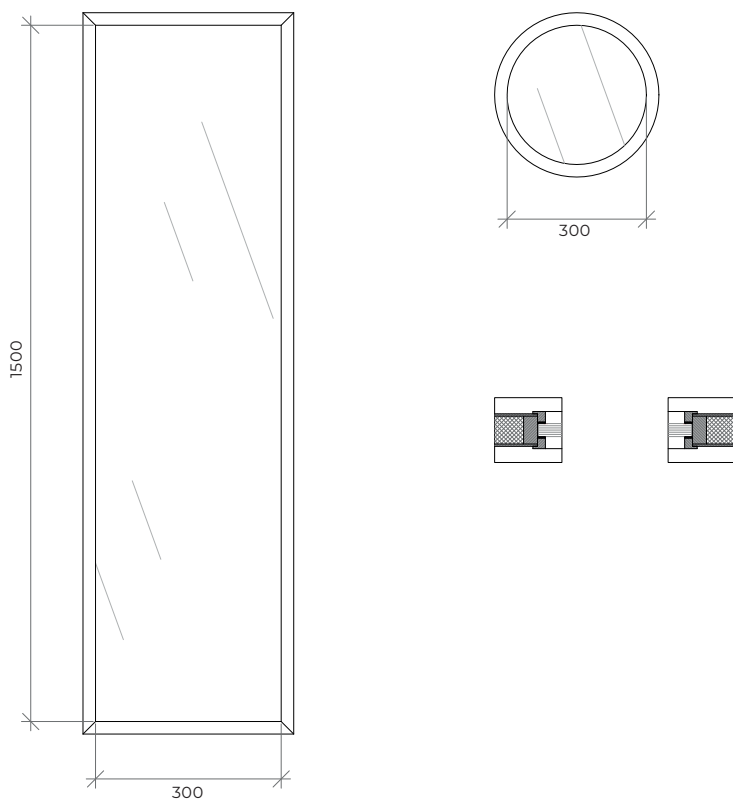

## accessories and hardware

<b>handle / bar <sup>(4)</sup></b>	1 standard	anti-panic lever handle with drill finished in black (standard) or stainless steel.
	2 standard	anti-panic bar with gear unit, tube, cover caps and arms finished in nylon black (standard) or stainless steel.
		<sup>(4)</sup> alternatively, the door may be equipped with a pair of handles.
<b>hydraulic door closer <sup>(5)</sup></b>	3 standard	door closers with articulated arms + closing sequence selector.
	optional	door closer with sliding rail + closing sequence selector.
		<sup>(5)</sup> with electromagnetic hold-open (optional).
<b>lock / counter lock</b>	4 standard	anti-panic lock + counter lock.
<b>cylinder</b>	5 standard	1/2 cylinder (european profile).
<b>hinges</b>	6 standard	visible hinges of this series.
<b>others</b>	7 optional	automatic seal.

# details

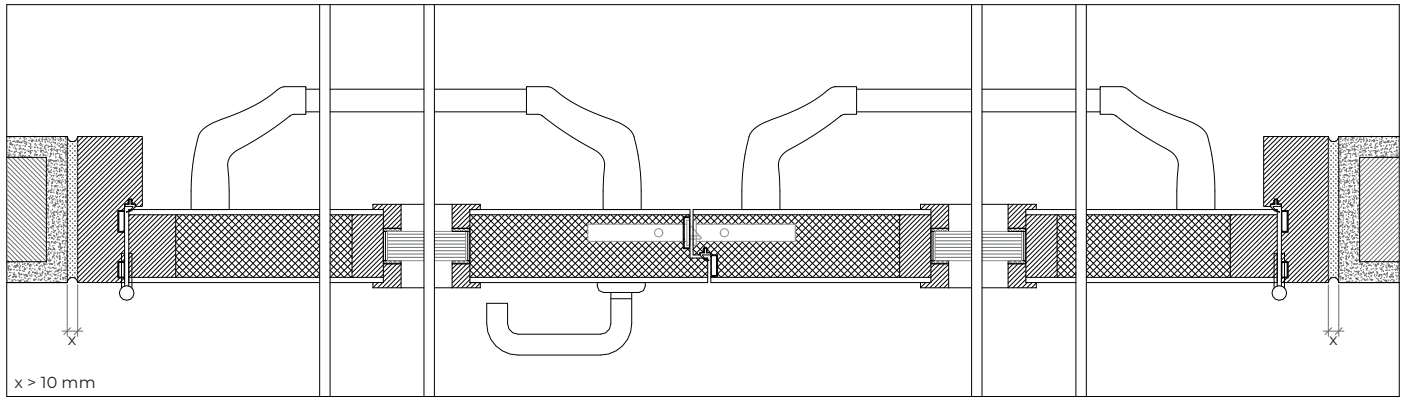

modified frame | visible hinges | concrete wall mounting | fixation with expandable foam

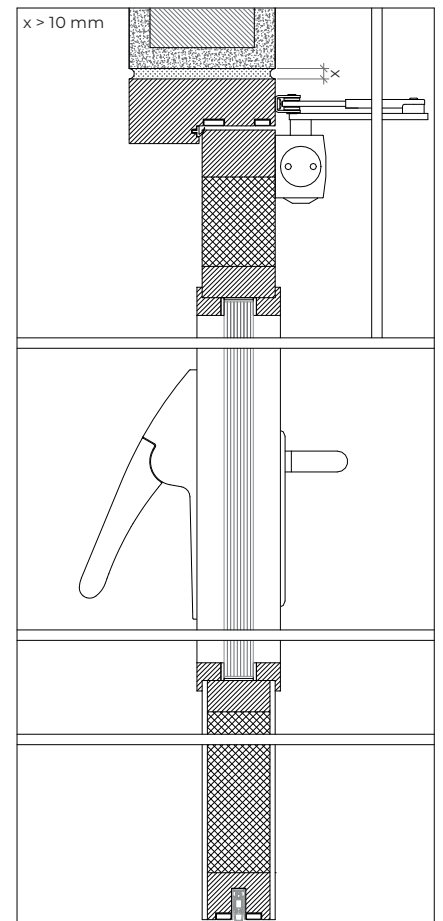
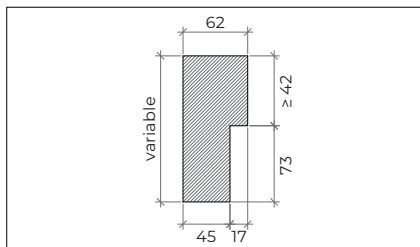

modified frame | door closer with articulated arm | concrete wall mounting | fixation with expandable foam

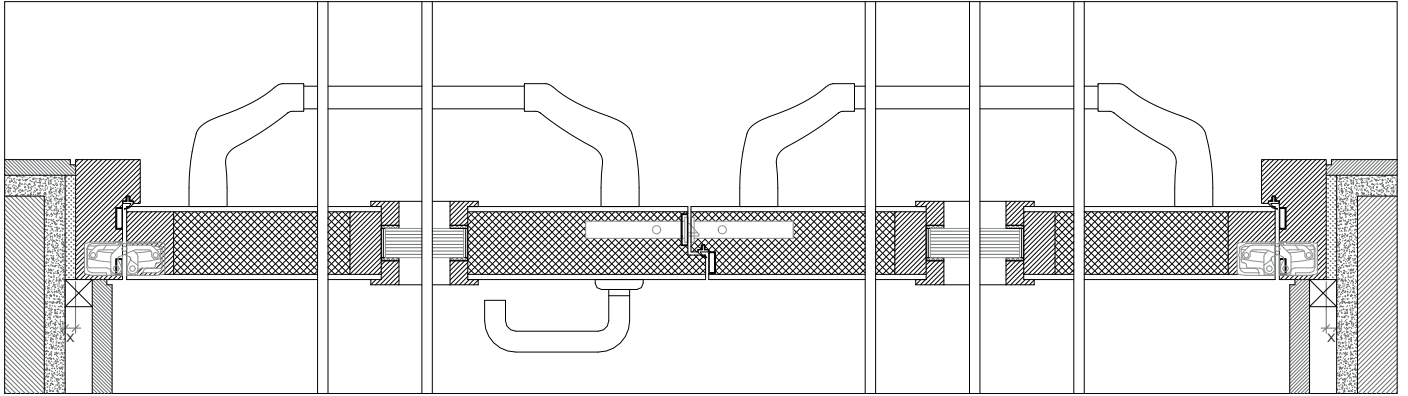

standard frame | hidden hinges | concrete wall mounting | fixation with expandable foam | plaster and wood finishes

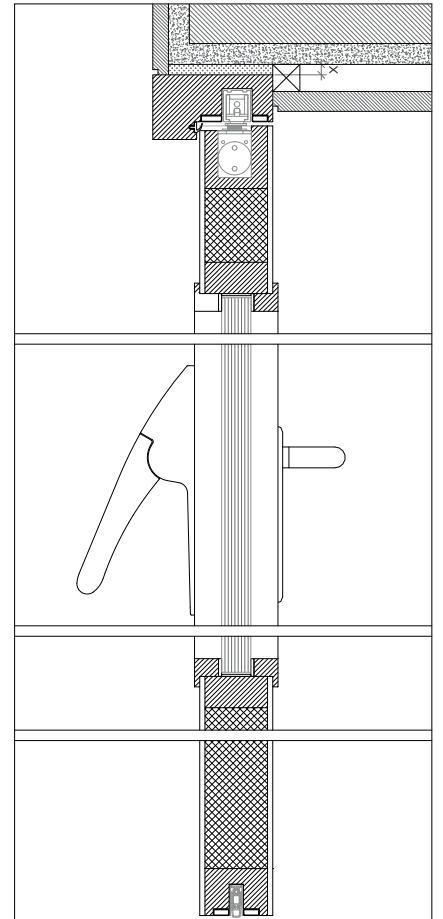
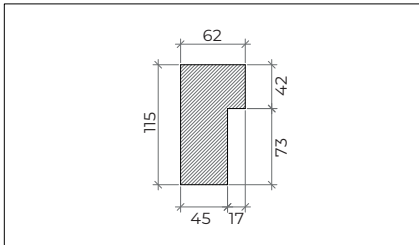

standard frame | hidden door closer | concrete wall mounting | fixation with expandable foam | plaster and wood finishes

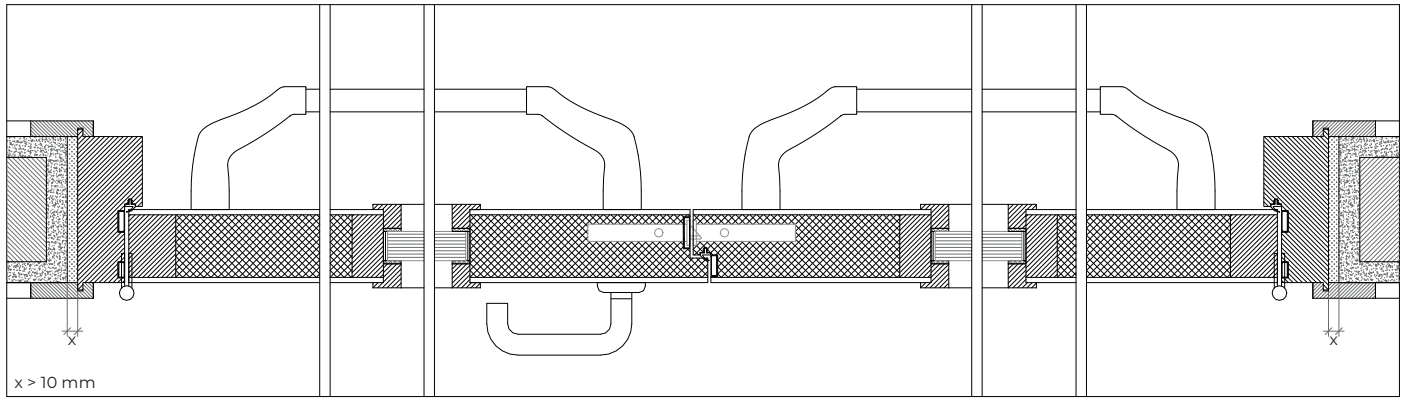

modified frame | visible hinges | concrete wall mounting | fixation with expandable foam | plaster and wood finishes

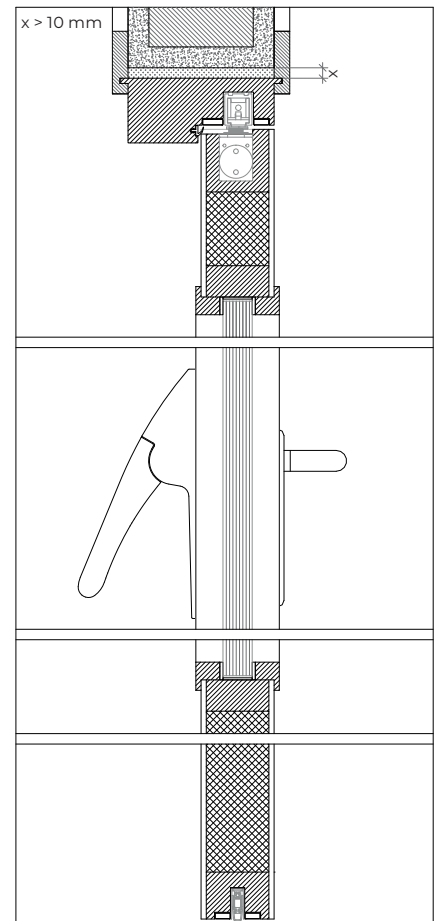
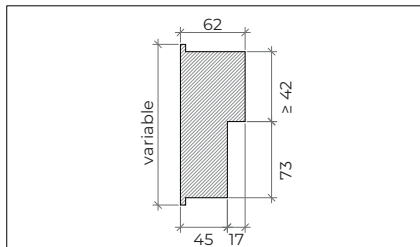

modified frame | hidden door closer | concrete wall mounting | fixation with expandable foam | plaster and wood finishes

GROUP COMPANY



---

**TRIA SA.**

Parque Ind. Manuel Lourenço Ferreira - Lt.43  
3450 - 232 Mortágua, Portugal  
//+351 231 927 480 //geral@tria.pt

**[www.tria.pt](http://www.tria.pt)**

VERS.10.22A